

# ***GENEST***

## **Block Shapes & Sizes**





Introducing

# G-MIX<sup>®</sup>

LOW CARBON CONCRETE



Available with up to 50% foamed recycled glass aggregate

## 50% LESS CEMENT & UP TO 55% RECYCLED MATERIAL WHILE EXCEEDING ASTM C90 SPECIFICATION REQUIREMENTS

Since 1985, Genest has been using less cement in concrete block production than most block producers, and now after years of experience and development, we are proud to introduce G-mix<sup>®</sup>. This formula uses up to 55% recycled aggregate and half of the cement traditionally used to produce concrete blocks. You can be confident that when you specify from Genest, you will have a low carbon footprint for your project.

The processing of cement, the primary binding agent in concrete, accounts for 75% of total carbon emissions by traditionally manufactured concrete. We offset the use of cement with slag, a byproduct from the steel industry, to reduce our carbon footprint. The materials we use to supplement cement have the added benefit of increasing strength and efficiency, improving color, and decreasing efflorescence.

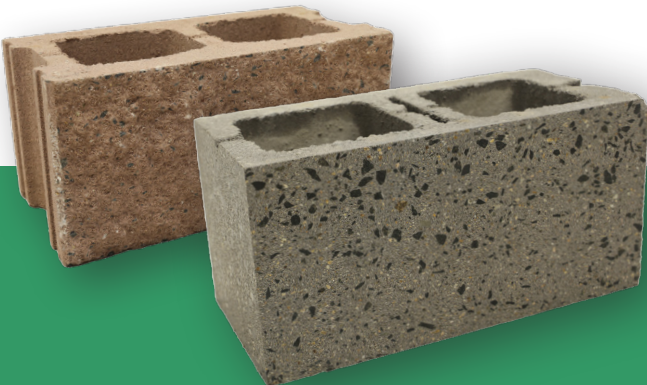

### G-MIX NORMAL WEIGHT ENVIRONMENTAL PRODUCT DECLARATION (EPD) DATA

Global Warming Potential (kg CO <sub>2</sub> -eq):	129
Acidification Potential (kg SO <sub>2</sub> -eq):	0.65
Eutrophication Potential (kg N-eq):	0.16
Smog Creation Potential (kg O <sub>3</sub> -eq):	12.9
Ozone Depletion Potential (kg CFC-11-eq):	5.99E-6

- ✓ 50% Less Cement
- ✓ Up to 55% Recycled Materials
- ✓ Exceeds Strength Requirements
- ✓ Third-Party Tested
- ✓ Locally Sourced Aggregate
- ✓ Low Carbon Footprint

**Normal Weight Option:**  
G-mix<sup>®</sup> 5% recycled content

**Lightweight Options:**  
G-mix<sup>®</sup>25 25% recycled content  
G-mix<sup>®</sup>45 45% recycled content  
G-mix<sup>®</sup>55 55% recycled content

The use of slag in our concrete formula results in greater cement reduction than typical CO<sub>2</sub> curing methods without compromising strength and durability. Our Environmental Product Declarations (EPDs), available at ASTM.org, show that the environmental impact of G-mix<sup>®</sup> is among the lowest in the industry. **The carbon footprint of our normal-weight architectural CMUs is over 65% lower than the industry average.\***

### COMPARISON OF CONCRETE MASONRY UNIT GLOBAL WARMING POTENTIAL

\*based on the Carbon Leadership Forum's 2021 Material Baseline Report

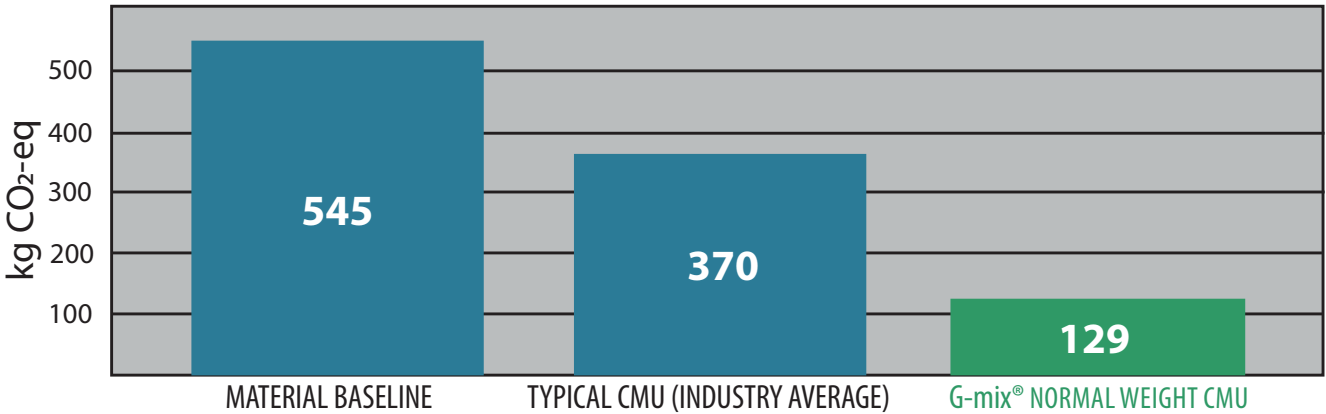

To further reduce our environmental impact, we have the ability to replace over 50% of the aggregate in our blocks with foamed recycled glass. In addition to reducing waste and the extraction of raw materials, this improves thermal efficiency and results in up to 25% weight reduction, producing a lighter weight block that still exceeds strength requirements. Lighter weight blocks significantly lower transportation costs and reduce carbon emissions associated with transport.



When you specify from Genest, you are making an environmentally responsible choice while ensuring that your project will continue to perform as designed for years to come. Contact us today for specification details!

G-mix was developed using proven methods of CO<sub>2</sub> reduction with quantifiable, verifiable results. The cradle-to-gate environmental impact of G-mix<sup>®</sup> has been third-party tested and ASTM-verified. Our Environmental Product Declarations (EPDs), published by ASTM, provide detailed information regarding the environmental impact of our extraction, transport, and manufacturing processes.





Genest architectural block is available in a wide variety of colors and finishes. Ask your Genest representative for a sample kit before making your final selection.

Architectural specifications, product guides, color and finish options, and other resources are available to download at [genestconcrete.com](http://genestconcrete.com).

To assist with designing and planning, Revit and SketchUp files for our Comfort Block systems are available at [CADdetails.com](http://CADdetails.com).



## Four Inch Block Shapes

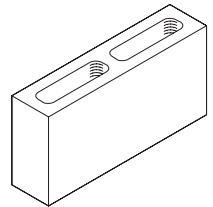

Stretcher  
 $3\frac{5}{8}'' \times 7\frac{5}{8}'' \times 15\frac{5}{8}''$

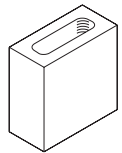

Half  
 $3\frac{5}{8}'' \times 7\frac{5}{8}'' \times 7\frac{5}{8}''$

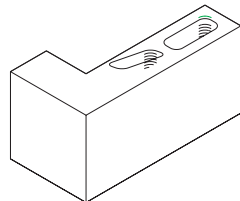

L-Corner  
 $3\frac{5}{8}'' \times 7\frac{5}{8}'' \times 15\frac{5}{8}''$

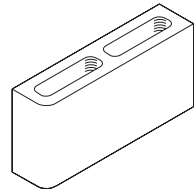

Single Bullnose  
 $3\frac{5}{8}'' \times 7\frac{5}{8}'' \times 15\frac{5}{8}''$

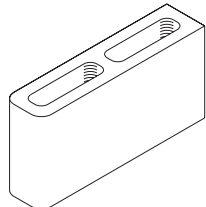

Double Bullnose  
 $3\frac{5}{8}'' \times 7\frac{5}{8}'' \times 15\frac{5}{8}''$

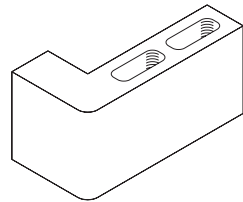

Single Bullnose L-Corner  
 $3\frac{5}{8}'' \times 7\frac{5}{8}'' \times 15\frac{5}{8}''$

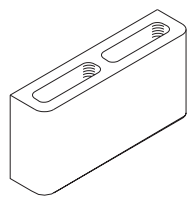

Double Bullnose Face  
 $3\frac{5}{8}'' \times 7\frac{5}{8}'' \times 15\frac{5}{8}''$

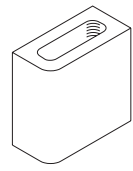

Single Bullnose Half  
 $3\frac{5}{8}'' \times 7\frac{5}{8}'' \times 7\frac{5}{8}''$

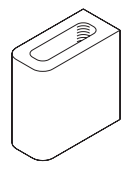

Double Bullnose Half  
 $5\frac{5}{8}'' \times 7\frac{5}{8}'' \times 7\frac{5}{8}''$

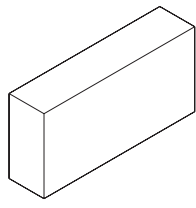

4" Solid  
 $3\frac{5}{8}'' \times 7\frac{5}{8}'' \times 15\frac{5}{8}''$

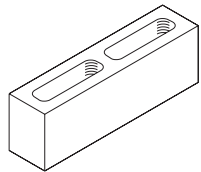

Starter  
 $3\frac{5}{8}'' \times 4\frac{5}{8}'' \times 15\frac{5}{8}''$

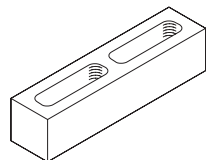

Half High  
 $3\frac{5}{8}'' \times 3\frac{5}{8}'' \times 15\frac{5}{8}''$

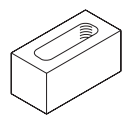

Half High Half  
 $3\frac{5}{8}'' \times 3\frac{5}{8}'' \times 7\frac{5}{8}''$

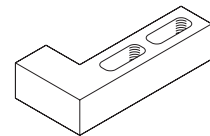

Half High L-Corner  
 $3\frac{5}{8}'' \times 3\frac{5}{8}'' \times 15\frac{5}{8}''$

## Manchester Block®

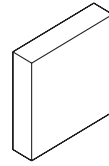

$3\frac{5}{8}'' \times 11\frac{5}{8}'' \times 11\frac{5}{8}''$

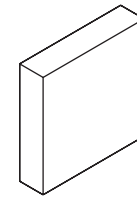

$3\frac{5}{8}'' \times 11\frac{5}{8}'' \times 11\frac{5}{8}''$

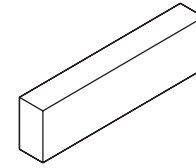

$3\frac{5}{8}'' \times 11\frac{5}{8}'' \times 11\frac{5}{8}''$

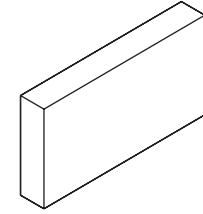

$3\frac{5}{8}'' \times 11\frac{5}{8}'' \times 11\frac{5}{8}''$

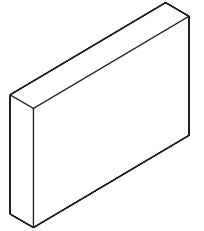

$3\frac{5}{8}'' \times 11\frac{5}{8}'' \times 11\frac{5}{8}''$

## Six Inch Block Shapes

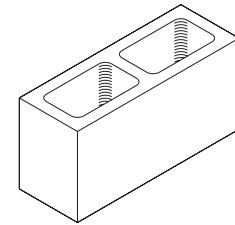

Stretcher  
 $5\frac{5}{8}'' \times 7\frac{5}{8}'' \times 15\frac{5}{8}''$

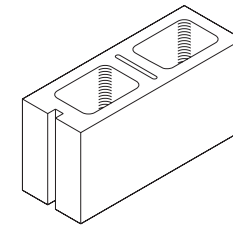

Combo  
 $5\frac{5}{8}'' \times 7\frac{5}{8}'' \times 15\frac{5}{8}''$

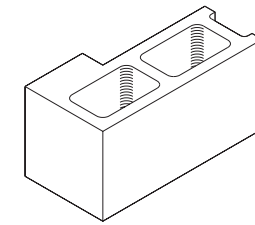

L-Corner  
 $5\frac{5}{8}'' \times 7\frac{5}{8}'' \times 15\frac{5}{8}''$

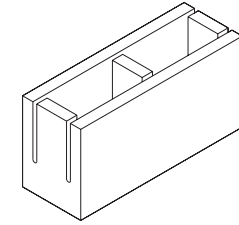

Bond Beam Knock Out  
 $5\frac{5}{8}'' \times 7\frac{5}{8}'' \times 15\frac{5}{8}''$

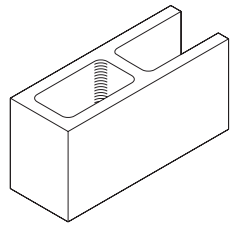

A-Block  
 $5\frac{5}{8}'' \times 7\frac{5}{8}'' \times 15\frac{5}{8}''$

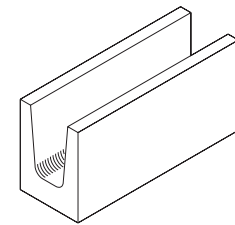

Bond Beam Solid  
 $5\frac{5}{8}'' \times 7\frac{5}{8}'' \times 15\frac{5}{8}''$

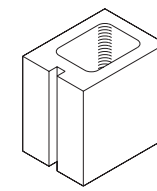

Half  
 $5\frac{5}{8}'' \times 7\frac{5}{8}'' \times 7\frac{5}{8}''$

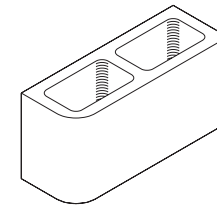

Single Bullnose  
 $5\frac{5}{8}'' \times 7\frac{5}{8}'' \times 15\frac{5}{8}''$

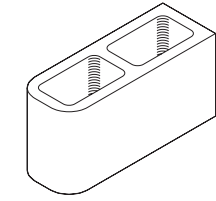

Double Bullnose  
 $5\frac{5}{8}'' \times 7\frac{5}{8}'' \times 15\frac{5}{8}''$

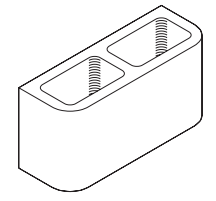

Double Bullnose Face  
 $5\frac{5}{8}'' \times 7\frac{5}{8}'' \times 15\frac{5}{8}''$

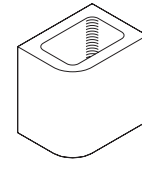

Single Bullnose Half  
 $5\frac{5}{8}'' \times 7\frac{5}{8}'' \times 7\frac{5}{8}''$

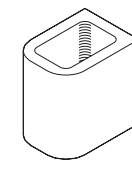

Double Bullnose Half  
 $5\frac{5}{8}'' \times 7\frac{5}{8}'' \times 7\frac{5}{8}''$

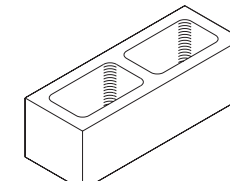

Starter  
 $5\frac{5}{8}'' \times 4\frac{5}{8}'' \times 15\frac{5}{8}''$

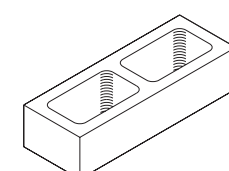

Half High  
 $5\frac{5}{8}'' \times 3\frac{5}{8}'' \times 15\frac{5}{8}''$

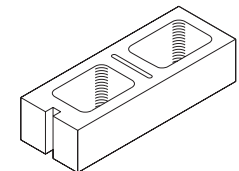

Half High Combo  
 $5\frac{5}{8}'' \times 3\frac{5}{8}'' \times 15\frac{5}{8}''$

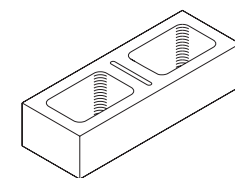

Half High Pier Combo  
 $5\frac{5}{8}'' \times 3\frac{5}{8}'' \times 15\frac{5}{8}''$

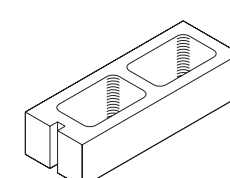

Half High Full Sash  
 $5\frac{5}{8}'' \times 3\frac{5}{8}'' \times 15\frac{5}{8}''$

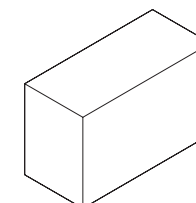

6" Solid  
 $5\frac{5}{8}'' \times 7\frac{5}{8}'' \times 15\frac{5}{8}''$



# Eight Inch Block Shapes

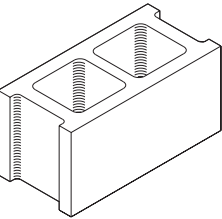

Stretcher  
7<sup>5</sup>/<sub>8</sub>" x 7<sup>5</sup>/<sub>8</sub>" x 15<sup>5</sup>/<sub>8</sub>"

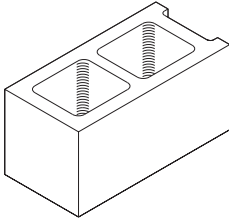

Corner  
9<sup>5</sup>/<sub>8</sub>" x 7<sup>5</sup>/<sub>8</sub>" x 15<sup>5</sup>/<sub>8</sub>"

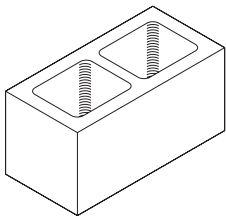

Pier  
7<sup>5</sup>/<sub>8</sub>" x 7<sup>5</sup>/<sub>8</sub>" x 15<sup>5</sup>/<sub>8</sub>"

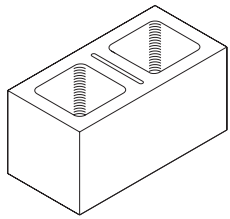

Pier Combo  
7<sup>5</sup>/<sub>8</sub>" x 7<sup>5</sup>/<sub>8</sub>" x 15<sup>5</sup>/<sub>8</sub>"

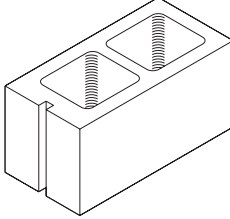

Full Sash  
7<sup>5</sup>/<sub>8</sub>" x 7<sup>5</sup>/<sub>8</sub>" x 15<sup>5</sup>/<sub>8</sub>"

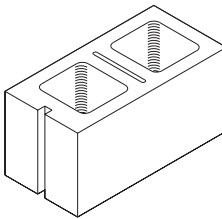

Combo  
7<sup>5</sup>/<sub>8</sub>" x 7<sup>5</sup>/<sub>8</sub>" x 15<sup>5</sup>/<sub>8</sub>"

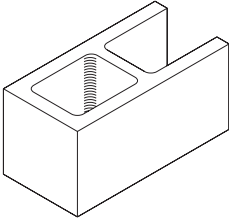

A-Block  
7<sup>5</sup>/<sub>8</sub>" x 7<sup>5</sup>/<sub>8</sub>" x 15<sup>5</sup>/<sub>8</sub>"

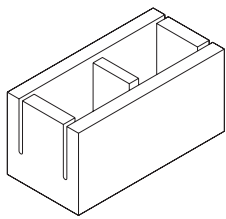

Bond Beam Knock Out  
7<sup>5</sup>/<sub>8</sub>" x 7<sup>5</sup>/<sub>8</sub>" x 15<sup>5</sup>/<sub>8</sub>"

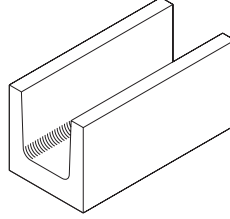

Bond Beam Solid  
7<sup>5</sup>/<sub>8</sub>" x 7<sup>5</sup>/<sub>8</sub>" x 15<sup>5</sup>/<sub>8</sub>"

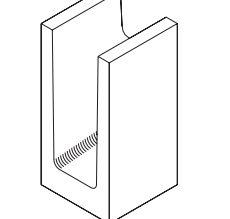

Beam Lintel  
7<sup>5</sup>/<sub>8</sub>" x 15<sup>5</sup>/<sub>8</sub>" x 7<sup>5</sup>/<sub>8</sub>"

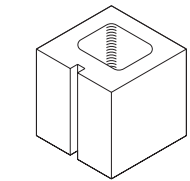

Half  
7<sup>5</sup>/<sub>8</sub>" x 7<sup>5</sup>/<sub>8</sub>" x 7<sup>5</sup>/<sub>8</sub>"

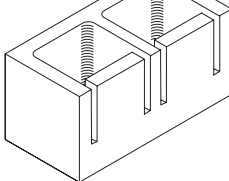

Grout Block  
7<sup>5</sup>/<sub>8</sub>" x 7<sup>5</sup>/<sub>8</sub>" x 15<sup>5</sup>/<sub>8</sub>"

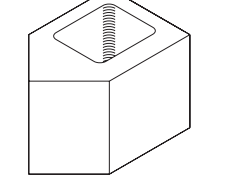

Splay Block  
7<sup>5</sup>/<sub>8</sub>" x 7<sup>5</sup>/<sub>8</sub>" x 7<sup>5</sup>/<sub>8</sub>"

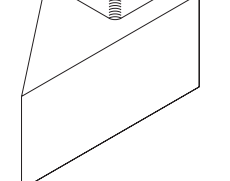

45 Degree Outside Corner  
7<sup>5</sup>/<sub>8</sub>" x 7<sup>5</sup>/<sub>8</sub>" x 7<sup>5</sup>/<sub>8</sub>" x 15<sup>5</sup>/<sub>8</sub>"

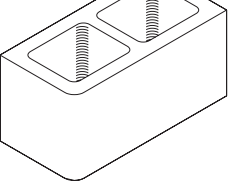

Single Bullnose  
7<sup>5</sup>/<sub>8</sub>" x 7<sup>5</sup>/<sub>8</sub>" x 15<sup>5</sup>/<sub>8</sub>"

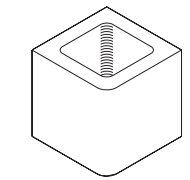

Single Bullnose Half  
7<sup>5</sup>/<sub>8</sub>" x 7<sup>5</sup>/<sub>8</sub>" x 7<sup>5</sup>/<sub>8</sub>"

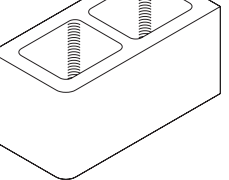

Double Bullnose  
7<sup>5</sup>/<sub>8</sub>" x 7<sup>5</sup>/<sub>8</sub>" x 15<sup>5</sup>/<sub>8</sub>"

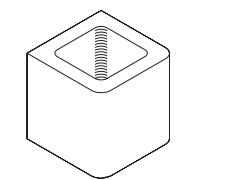

Double Bullnose Half  
7<sup>5</sup>/<sub>8</sub>" x 7<sup>5</sup>/<sub>8</sub>" x 7<sup>5</sup>/<sub>8</sub>"

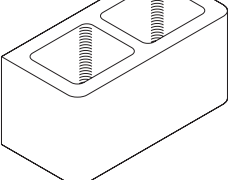

Double Bullnose Face  
7<sup>5</sup>/<sub>8</sub>" x 7<sup>5</sup>/<sub>8</sub>" x 15<sup>5</sup>/<sub>8</sub>"

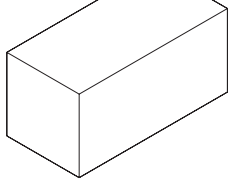

8" Solid  
7<sup>5</sup>/<sub>8</sub>" x 7<sup>5</sup>/<sub>8</sub>" x 15<sup>5</sup>/<sub>8</sub>"

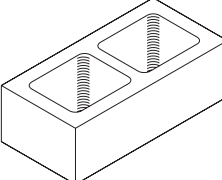

Starter  
7<sup>5</sup>/<sub>8</sub>" x 4<sup>5</sup>/<sub>8</sub>" x 15<sup>5</sup>/<sub>8</sub>"

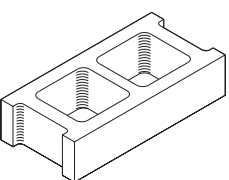

Half High  
7<sup>5</sup>/<sub>8</sub>" x 3<sup>5</sup>/<sub>8</sub>" x 15<sup>5</sup>/<sub>8</sub>"

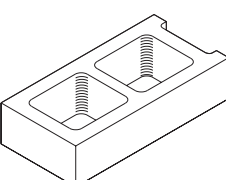

Half High Corner  
7<sup>5</sup>/<sub>8</sub>" x 3<sup>5</sup>/<sub>8</sub>" x 15<sup>5</sup>/<sub>8</sub>"

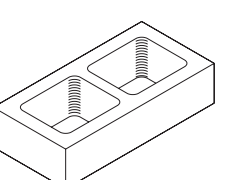

Half High Pier  
7<sup>5</sup>/<sub>8</sub>" x 3<sup>5</sup>/<sub>8</sub>" x 15<sup>5</sup>/<sub>8</sub>"

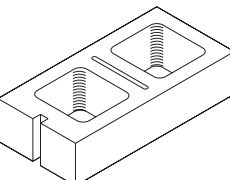

Half High Combo  
7<sup>5</sup>/<sub>8</sub>" x 3<sup>5</sup>/<sub>8</sub>" x 15<sup>5</sup>/<sub>8</sub>"



FULLY INSULATED  
R-19  
END BLOCKS  
ALSO AVAILABLE

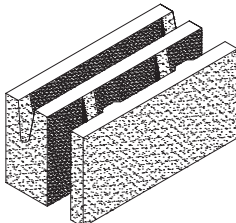

8" Omni Block  
7<sup>5</sup>/<sub>8</sub>" x 7<sup>5</sup>/<sub>8</sub>" x 15<sup>5</sup>/<sub>8</sub>"

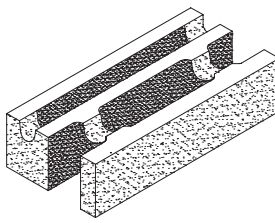

8" Omni Brick  
7<sup>5</sup>/<sub>8</sub>" x 3<sup>5</sup>/<sub>8</sub>" x 15<sup>5</sup>/<sub>8</sub>"

# Chimney Block Shapes

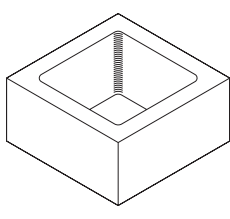

Chimney Full  
8" x 8"

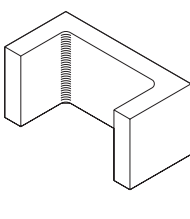

Chimney Half  
8" x 8"

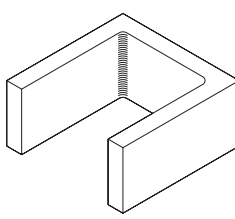

Adapter  
8" x 8"

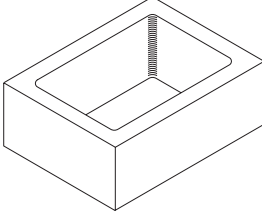

Chimney Full  
8" x 12"

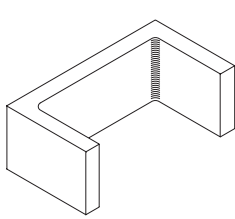

Chimney Half  
12" x 12"

# Ten Inch Block Shapes

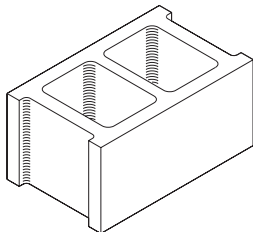

Stretcher  
9<sup>5</sup>/<sub>8</sub>" x 7<sup>5</sup>/<sub>8</sub>" x 15<sup>5</sup>/<sub>8</sub>"

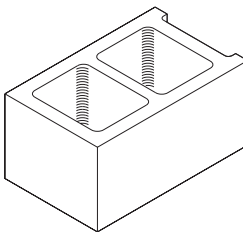

Corner  
9<sup>5</sup>/<sub>8</sub>" x 7<sup>5</sup>/<sub>8</sub>" x 15<sup>5</sup>/<sub>8</sub>"

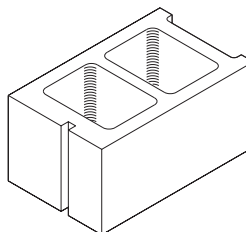

Full Sash  
9<sup>5</sup>/<sub>8</sub>" x 7<sup>5</sup>/<sub>8</sub>" x 15<sup>5</sup>/<sub>8</sub>"

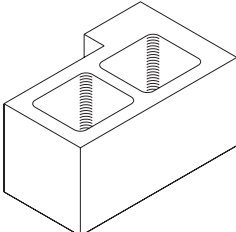

L-Corner  
9<sup>5</sup>/<sub>8</sub>" x 7<sup>5</sup>/<sub>8</sub>" x 15<sup>5</sup>/<sub>8</sub>"

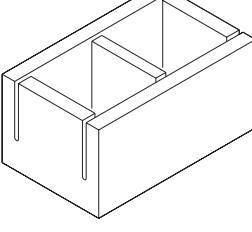

Bond Beam Knock Out  
9<sup>5</sup>/<sub>8</sub>" x 7<sup>5</sup>/<sub>8</sub>" x 15<sup>5</sup>/<sub>8</sub>"

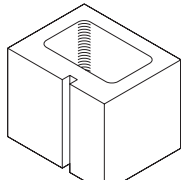

Half  
9<sup>5</sup>/<sub>8</sub>" x 7<sup>5</sup>/<sub>8</sub>" x 7<sup>5</sup>/<sub>8</sub>"

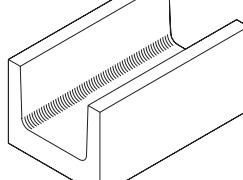

Bond Beam Solid  
9<sup>5</sup>/<sub>8</sub>" x 7<sup>5</sup>/<sub>8</sub>" x 15<sup>5</sup>/<sub>8</sub>"

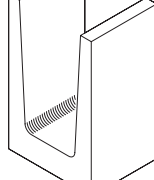

Beam Lintel  
9<sup>5</sup>/<sub>8</sub>" x 15<sup>5</sup>/<sub>8</sub>" x 7<sup>5</sup>/<sub>8</sub>"

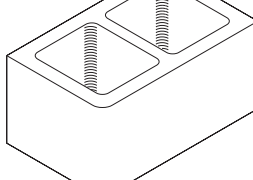

Single Bullnose  
9<sup>5</sup>/<sub>8</sub>" x 7<sup>5</sup>/<sub>8</sub>" x 15<sup>5</sup>/<sub>8</sub>"

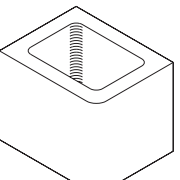

Single Bullnose Half  
9<sup>5</sup>/<sub>8</sub>" x 7<sup>5</sup>/<sub>8</sub>" x 7<sup>5</sup>/<sub>8</sub>"

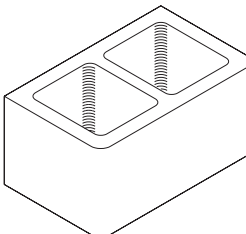

Double Bullnose  
9<sup>5</sup>/<sub>8</sub>" x 7<sup>5</sup>/<sub>8</sub>" x 15<sup>5</sup>/<sub>8</sub>"

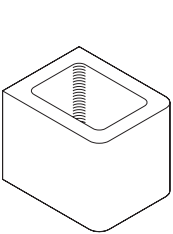

Double Bullnose Half  
9<sup>5</sup>/<sub>8</sub>" x 7<sup>5</sup>/<sub>8</sub>" x 7<sup>5</sup>/<sub>8</sub>"

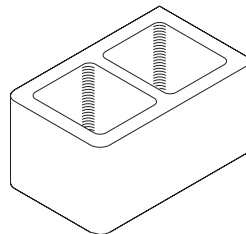

Double Bullnose Face  
9<sup>5</sup>/<sub>8</sub>" x 7<sup>5</sup>/<sub>8</sub>" x 15<sup>5</sup>/<sub>8</sub>"

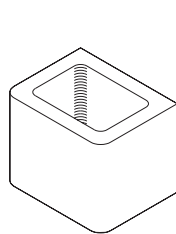

Double Bull Half Face  
9<sup>5</sup>/<sub>8</sub>" x 7<sup>5</sup>/<sub>8</sub>" x 7<sup>5</sup>/<sub>8</sub>"

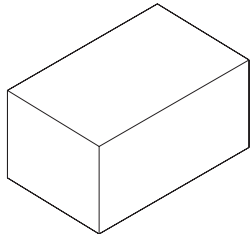

12" Solid  
9<sup>5</sup>/<sub>8</sub>" x 7<sup>5</sup>/<sub>8</sub>" x 15<sup>5</sup>/<sub>8</sub>"

# Twelve Inch Block Shapes

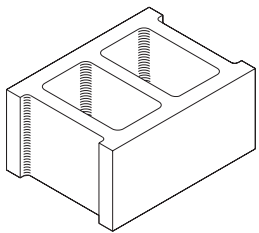

Stretcher  
11<sup>5</sup>/<sub>8</sub>" x 7<sup>5</sup>/<sub>8</sub>" x 15<sup>5</sup>/<sub>8</sub>"

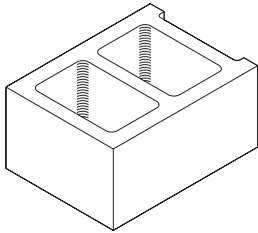

Corner  
11<sup>5</sup>/<sub>8</sub>" x 7<sup>5</sup>/<sub>8</sub>" x 15<sup>5</sup>/<sub>8</sub>"

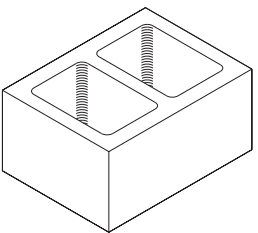

Pier  
11<sup>5</sup>/<sub>8</sub>" x 7<sup>5</sup>/<sub>8</sub>" x 15<sup>5</sup>/<sub>8</sub>"

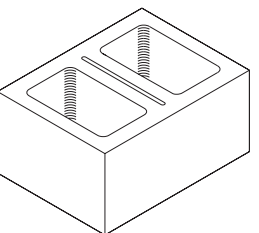

Pier Combo  
11<sup>5</sup>/<sub>8</sub>" x 7<sup>5</sup>/<sub>8</sub>" x 15<sup>5</sup>/<sub>8</sub>"

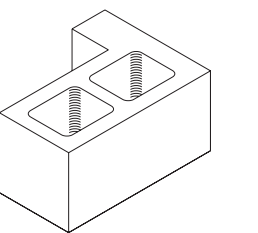

L-Corner  
11<sup>5</sup>/<sub>8</sub>" x 7<sup>5</sup>/<sub>8</sub>" x 15<sup>5</sup>/<sub>8</sub>"

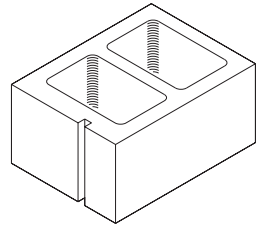

Full Sash  
11<sup>5</sup>/<sub>8</sub>" x 7<sup>5</sup>/<sub>8</sub>" x 15<sup>5</sup>/<sub>8</sub>"

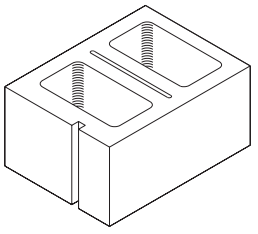

Combo  
11<sup>5</sup>/<sub>8</sub>" x 7<sup>5</sup>/<sub>8</sub>" x 15<sup>5</sup>/<sub>8</sub>"

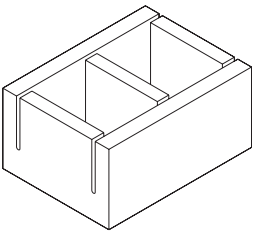

Bond Beam Knock Out  
11<sup>5</sup>/<sub>8</sub>" x 7<sup>5</sup>/<sub>8</sub>" x 15<sup>5</sup>/<sub>8</sub>"

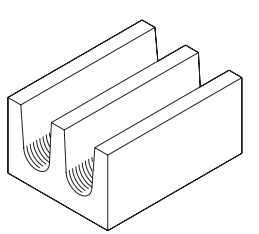

Solid Bottom Bond Beam  
11<sup>5</sup>/<sub>8</sub>" x 7<sup>5</sup>/<sub>8</sub>" x 15<sup>5</sup>/<sub>8</sub>"

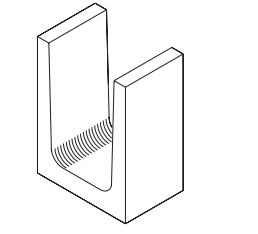

Beam Lintel  
11<sup>5</sup>/<sub>8</sub>" x 15<sup>5</sup>/<sub>8</sub>" x 7<sup>5</sup>/<sub>8</sub>"

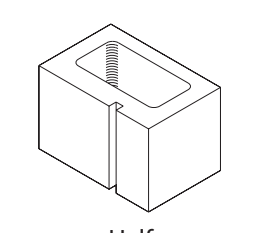

Half  
11<sup>5</sup>/<sub>8</sub>" x 7<sup>5</sup>/<sub>8</sub>" x 7<sup>5</sup>/<sub>8</sub>"

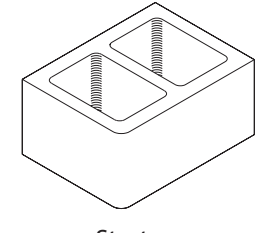

Starter  
11<sup>5</sup>/<sub>8</sub>" x 4<sup>5</sup>/<sub>8</sub>" x 15<sup>5</sup>/<sub>8</sub>"

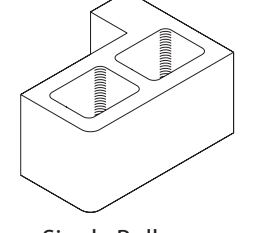

Single Bullnose  
11<sup>5</sup>/<sub>8</sub>" x 7<sup>5</sup>/<sub>8</sub>" x 15<sup>5</sup>/<sub>8</sub>"

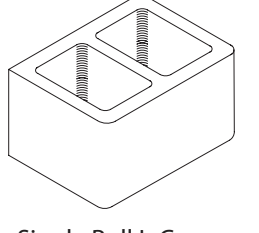

Single Bull L-Corner  
11<sup>5</sup>/<sub>8</sub>" x 7<sup>5</sup>/<sub>8</sub>" x 15<sup>5</sup>/<sub>8</sub>"

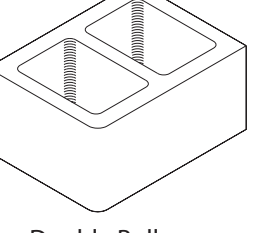

Double Bullnose  
11<sup>5</sup>/<sub>8</sub>" x 7<sup>5</sup>/<sub>8</sub>" x 15<sup>5</sup>/<sub>8</sub>"

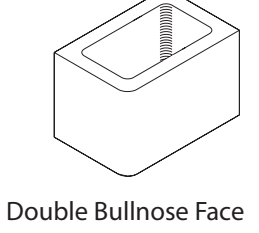

Double Bullnose Face  
11<sup>5</sup>/<sub>8</sub>" x 7<sup>5</sup>/<sub>8</sub>" x 15<sup>5</sup>/<sub>8</sub>"

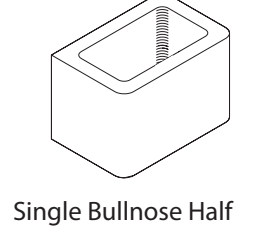

Single Bullnose Half  
11<sup>5</sup>/<sub>8</sub>" x 7<sup>5</sup>/<sub>8</sub>" x 7<sup>5</sup>/<sub>8</sub>"

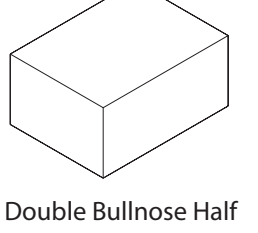

Double Bullnose Half  
11<sup>5</sup>/<sub>8</sub>" x 7<sup>5</sup>/<sub>8</sub>" x 15<sup>5</sup>/<sub>8</sub>"

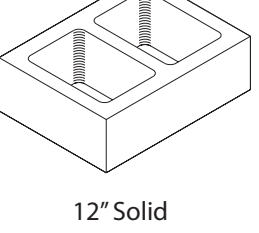

12" Solid  
11<sup>5</sup>/<sub>8</sub>" x 7<sup>5</sup>/<sub>8</sub>" x 15<sup>5</sup>/<sub>8</sub>"

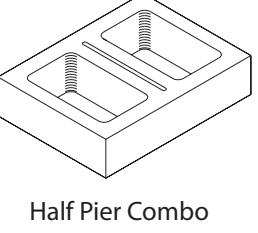

Half Pier Combo  
11<sup>5</sup>/<sub>8</sub>" x 3<sup>5</sup>/<sub>8</sub>" x 15<sup>5</sup>/<sub>8</sub>"

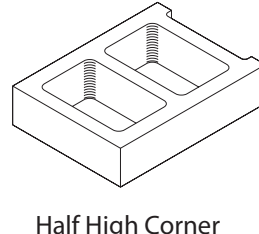

Half High Corner  
11<sup>5</sup>/<sub>8</sub>" x 3<sup>5</sup>/<sub>8</sub>" x 15<sup>5</sup>/<sub>8</sub>"

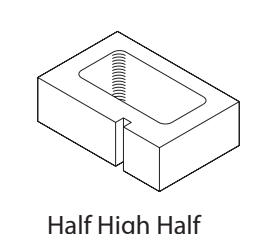

Half High Half  
11<sup>5</sup>/<sub>8</sub>" x 3<sup>5</sup>/<sub>8</sub>" x 7<sup>5</sup>/<sub>8</sub>"

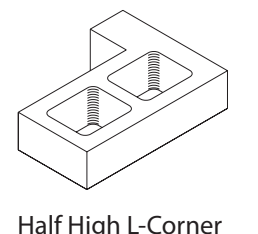

Half High L-Corner  
11<sup>5</sup>/<sub>8</sub>" x 3<sup>5</sup>/<sub>8</sub>" x 15<sup>5</sup>/<sub>8</sub>"

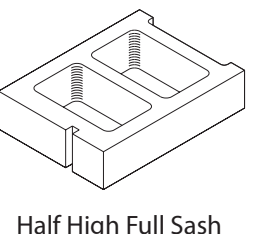

Half High Full Sash  
11<sup>5</sup>/<sub>8</sub>" x 3<sup>5</sup>/<sub>8</sub>" x 15<sup>5</sup>/<sub>8</sub>"

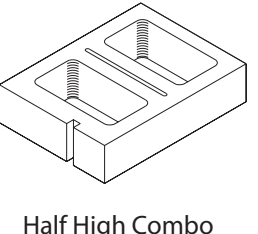

Half High Combo  
11<sup>5</sup>/<sub>8</sub>" x 3<sup>5</sup>/<sub>8</sub>" x 15<sup>5</sup>/<sub>8</sub>"

  
FULLY INSULATED  
R-29  
END BLOCKS  
ALSO AVAILABLE

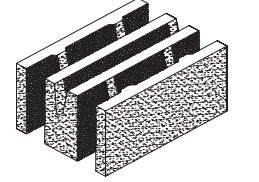

12" Omni Block  
11 5/8" x 7 5/8" x 15 5/8"

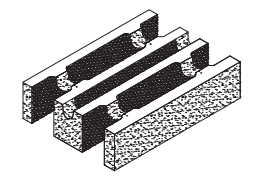

12" Omni Brick  
11 5/8" x 3 5/8" x 15 5/8"

# Sill Block

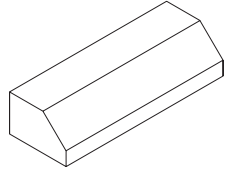

Custom sill blocks are available. A diagram is required for fabrication.  
Please inquire for more information at 800-649-4773.

# Standard Half-High Easy Brick®

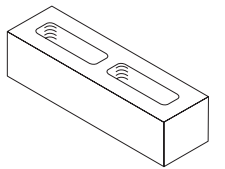

3<sup>5</sup>/<sub>8</sub>" x 3<sup>5</sup>/<sub>8</sub>" x 15<sup>5</sup>/<sub>8</sub>"

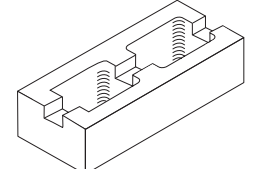
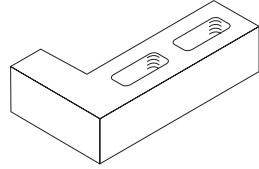

7<sup>5</sup>/<sub>8</sub>" x 3<sup>5</sup>/<sub>8</sub>" x 15<sup>5</sup>/<sub>8</sub>"

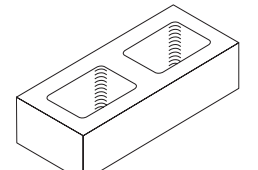
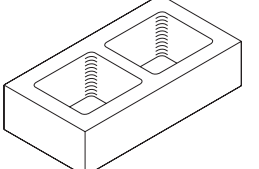

5<sup>5</sup>/<sub>8</sub>" x 3<sup>5</sup>/<sub>8</sub>" x 15<sup>5</sup>/<sub>8</sub>"

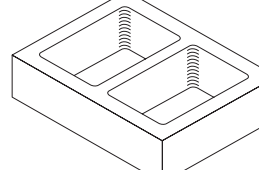
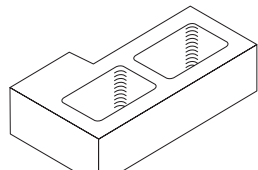

11<sup>5</sup>/<sub>8</sub>" x 3<sup>5</sup>/<sub>8</sub>" x 15<sup>5</sup>/<sub>8</sub>"

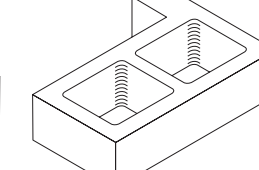

# Genest Architectural Brick

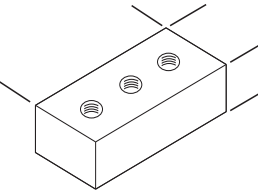

Stretcher

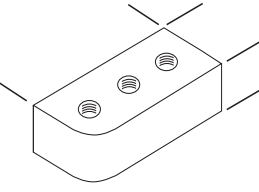

Single Bullnose

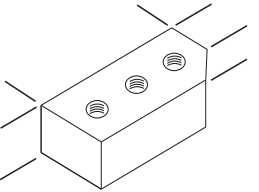

45° / Sill Corner

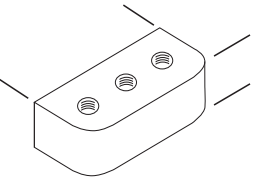

Double Bullnose

# Solid Block Shapes

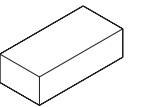

Concrete Brick  
2<sup>1</sup>/<sub>4</sub>" x 3<sup>5</sup>/<sub>8</sub>" x 7<sup>5</sup>/<sub>8</sub>"

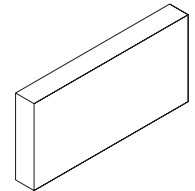

Soap  
1<sup>5</sup>/<sub>8</sub>" x 7<sup>5</sup>/<sub>8</sub>" x 15<sup>5</sup>/<sub>8</sub>"

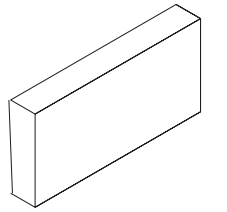

Patio  
2" x 7<sup>5</sup>/<sub>8</sub>" x 15<sup>5</sup>/<sub>8</sub>"

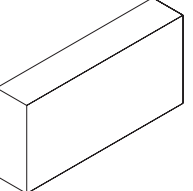

3" Solid  
2<sup>5</sup>/<sub>8</sub>" x 7<sup>5</sup>/<sub>8</sub>" x 15<sup>5</sup>/<sub>8</sub>"



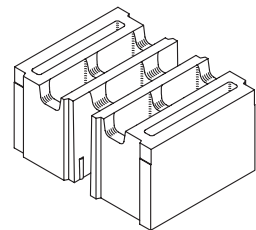

CB-16 Stretcher  
16"x8"x12"

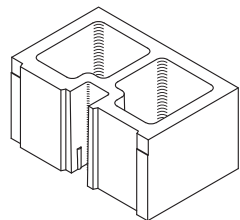

CB-16 Corner  
16"x8"x10"

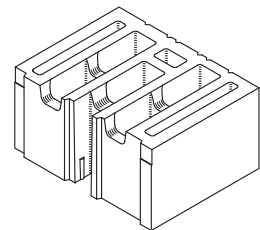

CB-16 Full Jamb  
16"x8"x12"

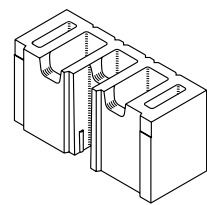

CB-16 Half Jamb  
16"x8"x6"

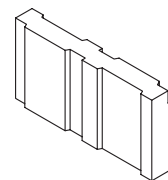

CB-16 Spacer  
16"x8"x2"

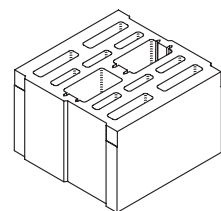

CB-12 Stretcher  
12"x8"x12"

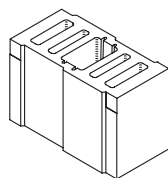

CB-12 Half  
12"x8"x6"

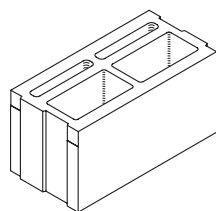

CB-8 Stretcher  
8"x8"x16"

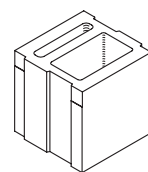

CB-8 Half  
8"x8"x8"

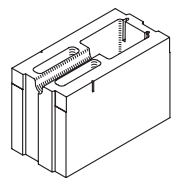

CB-6 Stretcher  
6"x8"x12"

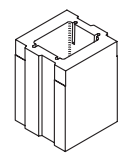

CB-6 Half  
6"x8"x6"

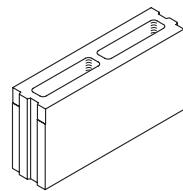

CB-4 Stretcher  
4"x8"x16"

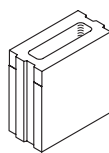

CB-4 Half  
4"x8"x8"

To assist with designing and planning, Revit and SketchUp files for all Comfort Block systems can be downloaded for free at [CADdetails.com](http://CADdetails.com).



## PRECISION GROUND CONCRETE WALL SYSTEM

Homes  
Buildings  
Landscaping



## Safe. Strong. Smart.®

Building with Comfort Block® is much easier and faster than traditional masonry construction. Precision engineering allows our blocks to be assembled using only adhesive, eliminating the need for mortar. An integrated electrical channel makes it easy to install the electrical system after construction.

Quickly and easily construct durable homes, buildings, landscaping features, and more with less waste of materials.

Comfort Block® is made with G-mix® so you can be confident that you will have a low-carbon footprint for your project.



**EASILY ASSEMBLED WITH MASONRY ADHESIVE**



**SOUND-REDUCING AND AIRTIGHT TO CREATE THE IDEAL INDOOR ENVIRONMENT**



**120+ MPH WIND RESISTANCE FOR PROTECTION FROM SEVERE WEATHER**



**ULTRA EFFICIENT — SAVE UP TO 75% IN HEATING & COOLING COSTS**



**RESISTS MOLD, MILDEW, AND PESTS TO KEEP YOUR BUILDING'S INTERIOR CLEAN AND HEALTHY**



**CB-16 SYSTEM IS 16" THICK WITH THREE LAYERS OF INTEGRATED INSULATION FOR SUPERIOR TEMPERATURE STABILITY**



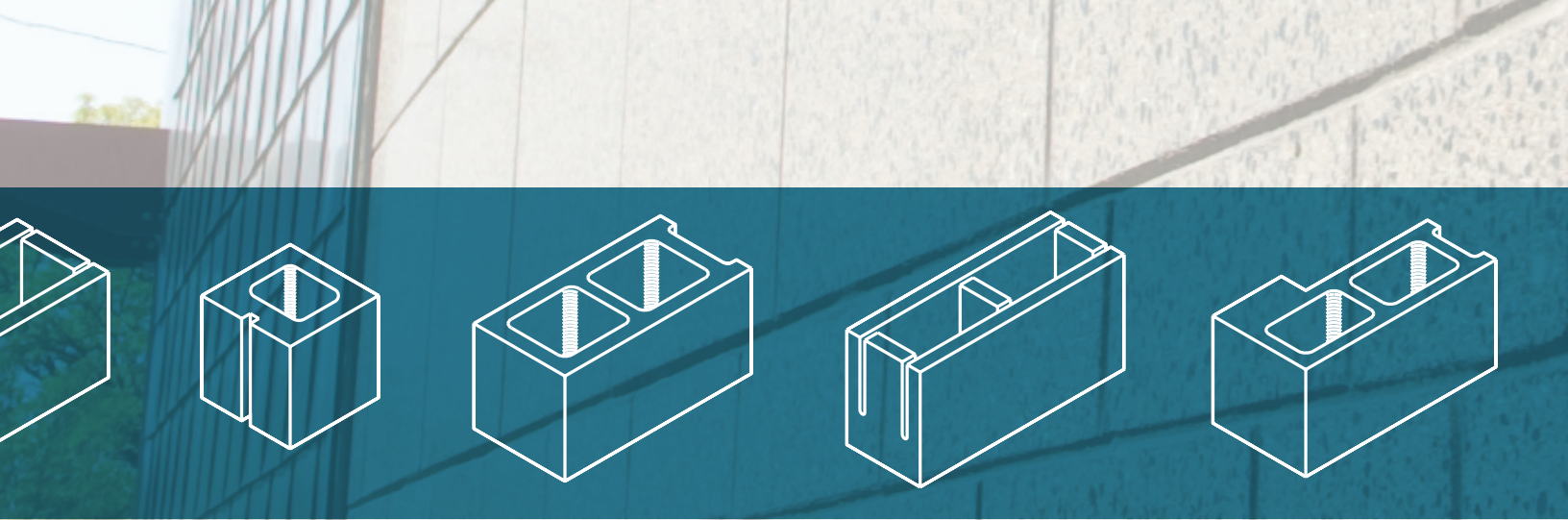

Genest has been manufacturing concrete products in southern Maine since 1927. We use Maine materials and Maine labor to make products that meet or exceed the highest industry standards. We are proud to manufacture our products in Maine, and we think you'll be proud to have them in your next project.

Genest is committed to practicing sustainable manufacturing. We have made it our mission to reduce the environmental impact of concrete construction through innovative engineering, the use of reclaimed and recycled materials as well as locally sourced aggregate, and monitoring of fossil fuels used during the manufacturing process. Our products are subject to ongoing, continual improvement as we continually challenge our materials and processes, pushing the boundaries of what a concrete block can be.



[WWW.GENESTCONCRETE.COM](http://WWW.GENESTCONCRETE.COM)

   GENESTCONCRETE

**1-800-649-4773**